



PO Box 549
Clemson, SC 29633
Toll-free: (866) 277-2883
Telephone: (864) 654-5886
Facsimile: (864) 654-5851
E-mail: nef@bellsouth.net



CAD/DESIGN/DRAFTING SCHOLARSHIP AWARD COMPETITION 2010-2011

Vicki A. Cromer, CIT, CDS
c/o John T. Morgan Roofing & Sheet Metal Co., Inc.
1620 Sixth Street NE
Roanoke, VA 24012
Phone 540-342-7498 Fax 540-345-2959
Email –vacrom20@netscape.com

**NAWIC Education Foundation
CAD/Design/Drafting Scholarship Award Competition
2010-2011
Table of Contents**

Chapter Representative Guidelines	3
Supplemental Support Materials and Forms	9
Quick Reference Guide	10
Worksheet for Key Dates and Prizes	11
Sample Letter to High Schools	12
Acknowledgement Letter to Students	13
Sample Press Release	14
Sample Request for Financial Sponsors	15
Time Line of Activities	16
Chapter Representative Submittal Forms	17
Regional Submittal Forms	19
Competition Critique Form	22
Oral Interview Form (optional)	23
Judging Form	24
Student Application Form	26
Design Problem and Project Requirements	27
Resource Material	34
Site Plan	35
Design Resources	36

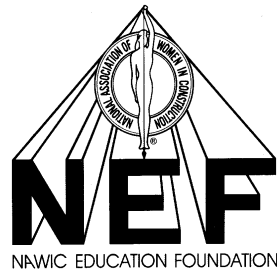

**NAWIC Education Foundation
CAD/DESIGN/DRAFTING
SCHOLARSHIP AWARD COMPETITION
2010-2011**

Chapter Representative Guidelines

NAWIC Education Foundation
CAD/Design/Drafting Scholarship Award Competition
2010-2011
Chapter Representative Guidelines

1. Structure of the Competition
 - A. The CAD/Design/Drafting Scholarship Award Competition for Senior High School students will be administered by the NAWIC Education Foundation.
 - B. Participating Chapter Representatives will select a CAD/Design/Drafting Scholarship Award Competition Chair to coordinate the competition.
 - C. In the event that there is no sponsoring local Chapter in the vicinity of a school or student that wishes to participate in the competition, the school or student can be referred to the Regional Director or Regional Competition Chair to see if another sponsoring Chapter in the Region will work with that school or student.
 - D. Contestants will be judged at the local level initially, and the local winners' entries, first place in each division, will be submitted for Regional Competition.
 - E. The winning entries of the Regional Competition will be submitted for National Competition.
2. Description of Each Competition Division
 - A. **Hand Drafting:** This competition provides recognition to students for creative design, successful problem solving, and craftsmanship in preparing architectural drawings. Entries will be evaluated for detail, accuracy, and originality of work.
 - B. **CAD:** This competition provides recognition to students for creative design, successful problem solving, and appropriate use of technology in preparing architectural drawings. Entries will be evaluated for detail, accuracy, and originality of the work.
3. Objectives
 - A. To introduce the student to the Construction industry in a positive and challenging manner.
 - B. To foster a sense of self-worth and to build confidence in the participant. Those choosing to enter the competition are capable of making competent decisions and working independently.
 - C. To encourage mentoring programs between students and educators.
4. Architectural Problem
 - A. Each Chapter Representative will be furnished with a "Design Problem" designed by a licensed architect, engineer or design professional.
 - B. The design problem will be generic enough to meet the needs of all areas of the United States.
 - C. The design problem will be selected by the NAWIC Education Foundation and the National CAD/Design/Drafting Competition Representative.

- D. Participants will be evaluated on the following:
- Line Weights
 - Orientation and Accuracy
 - Lettering
 - Creativity
 - Completeness
5. Eligibility
- A. Any high school student (grades 9 - 12), full or part time, may apply to enter the CAD/Design/Drafting Scholarship Award Competition through the sponsoring entity.
- B. Student may be in the United States and enrolled in:
- Public or Private High School
 - Vocational or Technical School (Must not have a HS Diploma or GED)
 - High School Equivalency Program
- C. Student does not have to be currently enrolled in a drafting or design class.
- D. Student may be home schooled, but the Chapter Representative must verify the grade equivalency of the student.
6. Entry Requirements
- A. Design project submitted must be limited to only one student per submittal (no teams). Student's entry must have the minimum of five required drawings and a maximum of seven required drawings to be judged.
- B. CAD only: Original disks may not be submitted. Submitted entries may be Blue Line or Black Line (Ozalid) prints, and/or Black Line photocopies. Original plots on bond paper only (no Mylar) may be submitted in black ink only. No color ink will be accepted.
- C. Hand Drafting only: No computer-drafted material will be allowed. Only original designs and freehand lettered drawings may be entered: i.e., no stencils or LeRoy lettering. Students may use guidelines and a straight-edge for vertical strokes. Submitted entries will be copies on Blue Line or Black Line (Ozalid) prints and/or Black Line photocopies. Do not submit original drawings.
- D. Drawings will be 24" x 36". All plan drawings will contain a NORTH arrow and all drawings will be labeled with the drawing scale.
- E. Drawing scale is found in item #5 Required Drawings in the "Design Problem".
- F. All drawings shall be plotted or drawn at the required scale. Do not plot the drawings "Scale To Fit" the sheet size.
- G. Drawings will not be returned to the students.
7. Fees and Supplies
- A. No fee will be charged to students for competing.
- B. Drafting supplies are the responsibility of the participant.

8. Entrant Information

- A. Each drawing submitted must bear the code number of the participant as administered by the Chapter Representative. The student's name should not appear on the drawings.
- B. Social Security numbers are required for the distribution of cash awards. If objections are raised to providing this information, the number may be added later to first place winners' applications before being forwarded to the next level of competition.
- C. Attached to each drawing set will be a plain opaque sealed envelope containing the required bottom portion of the student application showing:
 - Name, address, phone number, and class year of the participant.
 - Name, address, phone number of entrant's high school.
 - Name and phone number of entrant's drafting or design instructor, if applicable.
 - A statement signed by the student and instructor that the work is the student's own and that they did not receive outside help. (See Student Application Form).
- D. All entrants not adhering to the above criteria will be disqualified.

9. Judging – Chapter Level

- A. Judging of each project will be the responsibility of the chapter.
 - Judges will be comprised of professionals from the construction industry.
 - All judging will be conducted using the official judging form and other criteria as established by these guidelines.
 - Judges will evaluate entries on an individual basis.
 - All effort should be made to have each entry reviewed by at least three (3) judges to avoid individual bias.
- B. Judges will evaluate each project with the following point system:

• Design Narrative	20 Points
• Sheet A-1	20 Points
• Sheet A-2	35 Points
• Sheet A-3	30 Points
• Sheet A-4	30 Points
• Sheet A-5	25 Points
• Sheet A-6 – Optional Drawing #1	10 Points
• Sheet A-7 – Optional Drawing #2	<u>10 Points</u>
Total Points Possible	180 Points
- C. The Chapter Representative will be responsible for the following:
 - Entrant's name and school will be completely secured and completely covered for local judging purposes.

- Competition committee will tally points from the judges' rating sheets and identify the winner.
- Submit name of local winner and winning project to the Regional CAD/Design/Drafting Representative for further evaluation.
- Submittals to the Regional CAD/Design/Drafting Representative should contain the following:
 - 1) Copy of signed application form (both top and bottom portions)
 - 2) All required drawings with Design Narrative attached
 - 3) Chapter Representative Submittal Form
 - 4) Judging Forms
 - 5) Oral Interview Form (optional)
- Winning entries will be submitted to the Regional CAD/Design/Drafting Representative by the **date specified by the Regional Representative**, but it is recommended that it be no later than April 15, 2011.
- Chapter Representative will return the judging forms (make copies of the originals for the winner of each category) to the students for their review to understand in what areas their submittals were good and/or needed improvement.
- Members of the families of the judges are not eligible for the competition.

10. Judging – Regional Level

- A. The Regional CAD/Design/Drafting Representative will coordinate the judging process.
- B. Judges will be comprised of professionals from the construction industry.
- C. All judging shall be conducted using the criteria established by these guidelines (Item 9, Paragraphs A and B).
- D. Regional CAD/Design Drafting Representative shall return chapter and regional judging forms (except for the winner in each category) to the student or Chapter Representative for their review to understand in what areas their submittals were good and/or needed improvement.
- E. Winning Regional entries will be submitted to the National CAD/Design/Drafting Representative no later than **April 30, 2011**.

Vicki A. Cromer, CIT, CDS

c/o John T. Morgan Roofing & Sheet Metal Co., Inc.

1620 Sixth Street NE

Roanoke, VA 24012

Phone 540-342-7498

Fax 540-345-2959

Email –vacrom20@netscape.com

11. Judging – National Level

- A. A team of design professionals will be selected as judges for the National Competition by the National CAD/Design/Drafting Representative.

- B. National judges will evaluate the winning projects using the criteria as listed above (Item 9, Paragraphs A and B).
- C. Winners will be notified in writing by the NEF Executive Office.
- D. Judging forms will be returned to the students.

12. Prizes

- A. Chapter prizes for chapter competitions are the responsibility of the Chapter Representative.
- B. Regional prizes are the responsibility of the region. The Regional CAD/Design/Drafting Representative will coordinate and review the prize structure with their Regional Director. Each of the winning regional entries will be submitted for competition on the national level, becoming eligible for one of the national prizes.
- C. CAD Division only: National prizes for First, Second, and Third Place will be awarded.
 - First Place - \$1,500
 - Second Place - \$1,000
 - Third Place - \$ 500
- D. Hand Drafting Division only: National prize for First Place will be awarded.
 - First Place - \$1,500
- E. Each chapter and each region may have as many winning categories as they wish, but only one (1) entry for CAD and one (1) entry for Hand Drafting may be submitted for further consideration.
- F. The NAWIC Education Foundation will provide Certificates of Participation and an electronic logo upon request from the Chapter Representative or Regional Representative.

13. Selection of Winners

- A. Chapter winners will be selected by the **date specified by the Regional Representative**, but it is recommended that it be no later than April 15, 2011.
- B. Regional semi-finalists will be selected by **April 30, 2011**. Winners will be notified and prizes will be distributed by the Chapter Representative.
- C. National winners will be announced by **May 15, 2011**. All winners will be notified and prizes will be distributed by the NEF Executive Office.

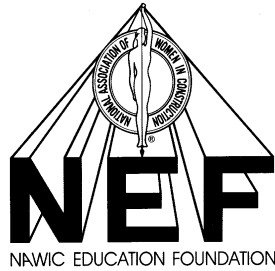

**NAWIC Education Foundation
CAD/DESIGN/DRAFTING
SCHOLARSHIP AWARD COMPETITION
2010-2011**

**Chapter Representative
Supplemental Support Materials
and Forms**

**NAWIC Education Foundation
CAD/Design/Drafting Scholarship Award Competition
2010-2011**

Quick Reference Guide

Upon receipt of this package, determine the following:

1. Set the date that student applications are due and where they are to be sent (it is recommended that the due date be before the end of December).
2. Determine when and where the completed drawings will be delivered.
3. Set the judging date. (Judge selection can be made at a later date.) Set date local awards are to be presented. (June is usually a very busy month and should be avoided, but awards should be made before school release.)
4. After the above has been determined, complete the blanks in the application forms, prepare your letter to the High School Drafting Instructors as well as the Principal/Dean, and mail.
5. Send press releases to local newspapers before you mail packages. This should create interest in the project if parents and educators see it.
6. **No site plan computer disk or CAD file is available for this project.**
7. When student applications are returned, make sure all information is correct and complete. Make sure forms are signed, and then send an acknowledgment letter to the student. Assign code numbers and student numbers.
8. Schedule a class period where you can meet the students and answer questions from the students and instructors.
9. After drawings are completed and have been submitted, number the drawings or use prior assigned codes so that the drawings are anonymous.
10. Start judging. Your first place project in each division (CAD and Hand Drafting) goes to the Regional CAD/Design/Drafting Representative for the Regional Competition.
11. Winning projects of the Regional Semi-Finals will be sent to the National CAD/Design/Drafting Representative for the National Competition.

**NAWIC Education Foundation
CAD/Design/Drafting Scholarship Award Competition
2010-2011**

Worksheet for Key Dates and Prizes

APPLICATION AND ENTRIES

1. Application for entry to be received no later than _____.
2. Completed project to be submitted for judging on _____.
3. Judging will be held _____.
4. Presentation of awards will be _____.
5. Details about Regional and National Competition will be coming soon.

RULES AND REGULATIONS OF THE CONTEST

1. Any senior high school student, full or part time, enrolled in public or private senior high school, vocational or technical school, or a high school equivalency program or a home schooled senior high school student may apply to enter the competition, with the approval of his/her parent(s) or guardian and school instructor.
2. Judges will be comprised of professionals from the construction industry.
3. Entries will be evaluated for detail, accuracy, and originality of work.
4. Awards:

		CAD	Drafting
Chapter Awards:	1 st Place	_____	_____
	2 nd Place	_____	_____
	3 rd Place	_____	_____
Regional Award:	1 st Place	_____	_____
	2 nd Place	_____	_____
	3 rd Place	_____	_____
National Award:	1 st Place	\$1,500	\$1,500
	2 nd Place	\$1,000	n/a
	3 rd Place	\$500	n/a

NAWIC Education Foundation

CAD/Design/Drafting Scholarship Award Competition 2010-2011

Sample Introductory Letter to High Schools

(Use Chapter Letterhead)

Date:

To: Drafting or Industrial Arts Instructor

From: Jane Doe, Construction Industry Committee or Competition Representative

Re: CAD/Design/Drafting Scholarship Award Competition

The _____ Chapter of the National Association of Women in Construction (NAWIC) is sponsoring a CAD/Design/Drafting Scholarship Awards competition for high school students for the 201__-201__ school year, and we wish to encourage you and your students to participate.

The contest provides recognition to students for creative design, successful problem solving, and craftsmanship in preparing architectural drawings and renderings. Drawings may be submitted in the category of "Hand Drafting" or the category of "CAD Drafting."

Your students will be furnished with a Design Problem created by a design professional, a site description and plan, and a list of required drawings. Contestants will be judged at the local level by construction industry professionals, and the local winner's entry will be submitted for Regional Competition. Regional winners will be submitted for National Competition.

The members of the _____ Chapter of NAWIC believe the challenge of meeting future workforce demands requires immediate attention to the importance of educating, training, and preparing our youth for careers in construction.

We hope you will encourage your students to enter this competition and look forward to hearing from you and from them.

Competition Representative
(Contact information)

**NAWIC Education Foundation
CAD/Design/Drafting Scholarship Award Competition
2010-2011**

Sample Acknowledgment Letter to Students

(Use Chapter Letterhead)

December, 201__ or January, 201__

Dear _____:

Your application to enter the High School CAD/Design/Drafting Scholarship Award Competition for the 201__-201__ school year has been received. We are delighted that you have accepted this challenge.

The following is your code number to use in the submission of your project:
Code No. : _____

Your completed presentation is to be submitted for judging to the following address no later than _____, _____.

Be sure to place the required bottom portion of your Student Application Form in a plain envelope and attach it to the back of the Site Plan.

If you have any questions, please do not hesitate to call me at _____.

The members of the _____ Chapter of NAWIC are anxious to see your accomplishments. GOOD LUCK!

Competition Chair or Construction industry Representative

**NAWIC Education Foundation
CAD/Design/Drafting Scholarship Award Competition
2010-2011**

Sample Press Release

(Fill in necessary information. Please individualize this release.)

FOR IMMEDIATE RELEASE: Month, day, 201__

FOR FURTHER INFORMATION CALL: Chair's Name and Phone Number

CAD/DESIGN/DRAFTING SCHOLARSHIP AWARD COMPETITION

The _____ Chapter of the National Association of Women in Construction (NAWIC) will sponsor a CAD/Design/Drafting Scholarship Award Competition for senior high school students in the _____ (school district/city). This competition is administered by the NAWIC Education Foundation in an effort to create an awareness of job opportunities in the construction industry.

The NAWIC Education Foundation is a Texas-based, non-profit (IRS 501c3) corporation operating to provide and promote educational opportunities and programs to benefit the Construction industry throughout the United States.

The competition provides recognition to students for creative design, successful problem solving, and craftsmanship in preparing architectural drawings and renderings. Drawings may be submitted in the category of "Hand Drafting" or the category of "CAD Drafting."

Entries will be evaluated for detail, accuracy, and originality of work. Contestants will be judged at the local level initially, and the local winner's entry in each category will be submitted for Regional and National Competition.

Students will be furnished with an architectural problem developed by a design professional, a site description and plan, and a listing of drawings required. Judging will be performed by construction industry professionals.

The members of the _____, # _____, of NAWIC believe the challenge of meeting future workforce demands requires immediate attention to the importance of education, training, and preparing our youth for careers in construction.

**NAWIC Education Foundation
CAD/Design/Drafting Scholarship Award Competition
2010-2011**

Sample Request for Financial Sponsors

(Fill in necessary information. Please individualize this letter.)

Month, day, 201_

Company Representative
Company Address

Dear _____,

Thank you for the opportunity to tell you about the National Association of Women in Construction (NAWIC) Education Foundation CAD/Design/Drafting Scholarship Award Competition. This competition was designed to introduce students to the construction industry in a positive and challenging manner, to foster a sense of self-worth, to build confidence in the participants, and to encourage mentoring programs between students, educators, and the industry.

This year (Name of Chapter) is proud to sponsor the Competition for CAD/Drafting students from (names of schools or districts).

NAWIC is seeking financial sponsors for the cash awards and other expenses of the competition. We hope to raise (amount needed) in prize money and would like each participant to leave the contest with gift certificates and merchandise. In addition, we would like to give our judges gifts for offering their time and expertise to the competition.

The judging for this competition will be held (date) at (location) and the prizes will be awarded no later than (date). NAWIC truly appreciates your support of education in our community and your support of the construction industry.

Sincerely,

Competition Chair or Construction industry Representative
NAWIC _____ Chapter
Contact information and where to send donations.

**NAWIC Education Foundation
CAD/Design/Drafting Scholarship Award Competition
2010-2011**

Time Line of Activities

DATE	ACTIVITY
April/May/June	Contact schools/instructors with next year's design problem. Get the design problem to them as early as possible so the instructor can incorporate it into the curriculum for the upcoming school year.
September	Contact the Instructors to possibly meet with them to discuss the competition. Gain their support. Schedule a visit to the class or a workshop if more than one school participates.
December	Set the deadline prior to winter vacation for student applications to be received. Check applications for compliance. Send letters of acknowledgment and encouragement. Assign code numbers, so that entries will be anonymous.
January 15	Send Regional Applicant Submittal Form (p.19) to National Rep.
February	Send school/students letters of encouragement. Remind students of deadlines.
March 15 – April 1	Recommended dates that submittals are due for chapter judging. Start and complete judging. Select chapter winner.
April 15	Recommended date that winning chapter entries are due to Regional CAD/Design/Drafting Representative for Regional Competition. Select Regional Winner – if timing applies, announce winners at Regional Forum.
April 30	Winning Regional entries due to CAD/Design/Drafting National Representative for National Competition. This deadline is absolute!
May 15	Announce National Winners.
April/May/June	Perhaps you might invite your students or winners to a "recognition" night, awards ceremony, or a chapter meeting. Invite a career-oriented or industry speaker to your meeting. This is an excellent time to make award presentations.

These are recommended guidelines to help the competition gain the most exposure. Your chapter can get started with as little as one school in your area. Site visits to the school are only a suggestion; questions can be answered over the phone.

NAWIC Education Foundation
CAD/Design/Drafting Scholarship Award Competition
2010-2011
Chapter Representative Submittal Form
CAD Division

NAWIC Chapter or
Sponsor Name: _____ Sponsor Chapter #: _____

CAD/Design/Drafting Chair: _____

Address: _____ Phone #: _____

Total CAD student applications received _____

Total CAD entries received _____

Winning Participant: _____

Winning Participant Code: _____

Address: _____

Phone #: _____ Social Security #: _____

Parent/Guardian Name: _____

Complete this form and forward to your Regional Representative with all of the following
by **the deadline specified by the Regional Representative**:

- Signed student application form (both top and bottom portions)
- Judging forms; make copies to return to participant
- Oral Interview Form (optional)
- All required drawings
- Design Narrative attached to drawings

It is suggested that you put all loose papers together in one envelope, to avoid loss in
transport to the next judging levels.

Please complete the **Chapter Competition Critique Form** found on page 22 and send
to the NEF CAD/Design Drafting Chair (see page 22 for instructions).

NAWIC Education Foundation
CAD/Design/Drafting Scholarship Award Competition
2010-2011
Chapter Representative Submittal Form
Hand Drafting Division

NAWIC Chapter or
Sponsor Name: _____ Sponsor Chapter #: _____

CAD/Design/Drafting Chair: _____
Address: _____ Phone #: _____

Total Hand Drafting student applications received _____

Total Hand Drafting entries received _____

Winning Participant: _____

Winning Participant Code: _____

Address: _____

Phone #: _____ Social Security #: _____

Parent/Guardian Name: _____

Complete this form and forward to your Regional Representative with all of the following
by **the deadline specified by the Regional Representative**:

- Signed student application form (both top and bottom portions)
- Judging forms; make copies to return to participant
- Oral Interview Form (optional)
- All required drawings
- Design Narrative attached to drawings

It is suggested that you put all loose papers together in one envelope to avoid loss in transport to the next judging levels.

Please complete the **Chapter Competition Critique Form** found on page 22 and send to the NEF CAD/Design Drafting Chair (see page 22 for instructions).

**NAWIC Education Foundation
CAD/Design/Drafting Scholarship Award Competition
2010-2011
Regional Applicant Submittal Form**

Region: _____ Regional Representative: _____

E-mail: _____ Phone: _____

Number of Chapters participating in Region: (use additional sheets if needed)

Chapter #	Chapter Name	# Registered CAD Students	# Registered Hand- Drafting Students
Total participants in Region:		CAD _____	Hand _____

Obtain information from each participating chapter, complete this form, and send it to the National Chair no later than **January 15, 2011**.

2010-2011 National Chair: **Vicki A. Cromer, CIT, CDS**
c/o John T. Morgan Roofing & Sheet Metal Co., Inc.
1620 Sixth Street NE
Roanoke, VA 24012
Phone 540-342-7498
Fax 540-345-2959
Email –vacrom20@netscape.com

**NAWIC Education Foundation
CAD/Design/Drafting Scholarship Award Competition
2010-2011
Regional Submittal Form – CAD Division**

Region: _____ Regional Representative: _____

Regional Rep. Chapter Name/Number: _____

Address: _____

Phone: _____ Fax: _____

Number of Chapters participating in Region: (use additional sheets if needed)

Chapter #	Chapter Name	# Registered Students	# Judged Entries	# Incomplete Entries/ not Judged

Total CAD participants in Region: _____

Winning Chapter or Sponsor Name/Number: _____

Winning CAD Participant: _____

Winning Participant Code: _____

Regional Representative's Comments: _____

Complete form and forward to the National Chair with the following by **April 30, 2011**:

- Signed student application form (both top and bottom portions)
- Judging forms (chapter and regional)
- Oral Interview Form (optional)
- All required drawings
- Design Narrative attached to drawings

It is suggested that you put all loose papers together in one envelope to avoid loss in transport to the next judging level.

2010-2011 National Chair:
Vicki A. Cromer, CIT, CDS
c/o John T. Morgan Roofing & Sheet Metal Co., Inc.
1620 Sixth Street NE
Roanoke, VA 24012
Phone 540-342-7498
Fax 540-345-2959
Email –vacrom20@netscape.com

**NAWIC Education Foundation
CAD/Design/Drafting Scholarship Award Competition
2010-2011**

Regional Submittal Form – Hand Drafting Division

Region: _____ Regional Representative: _____

Regional Rep. Chapter Name/Number: _____

Address: _____

Phone: _____ Fax: _____

Number of Chapters participating in Region: (use additional sheets if needed)

Chapter #	Chapter Name	# Registered Students	# Judged Entries	# Incomplete Entries/ not Judged

Total Hand Drafting participants in Region: _____

Winning Chapter or Sponsor Name/Number: _____

Winning Hand Drafting Participant: _____

Winning Participant Code: _____

Regional Representative's Comments: _____

Complete form and forward to the National Chair with the following by **April 30, 2011**:

- Signed student application form (both top and bottom portions)
- Judging forms (chapter and regional)
- Oral Interview Form (optional)
- All required drawings
- Design Narrative attached to drawings

It is suggested that you put all loose papers together in one envelope to avoid loss in transport to the next judging level. **2010-2011 National Chair:**

Vicki A. Cromer, CIT, CDS

c/o John T. Morgan Roofing & Sheet Metal Co., Inc.

1620 Sixth Street NE Roanoke, VA 24012

Phone 540-342-7498 Fax 540-345-2959 Email –vacrom20@netscape.com

**NAWIC Education Foundation
CAD/Design/Drafting Scholarship Award Competition
2010-2011**

Chapter Competition Critique Form

(To be completed by the Chapter Representative)

Please critique this program. Your response will help improve this program to better enable the NAWIC Education Foundation to meet its goals.

NAWIC Chapter or Sponsor Name: _____ Chapter # _____

CAD/Design/Drafting Chair: _____

1. Were the materials provided adequate? ____ Yes ____ No

If no, why not? _____

What information did you need? _____

2. Did you find the program difficult to administer? ____ Yes ____ No

3. Did your chapter provide an adequate budget for this program? ____ Yes ____ No

4. Were the teachers receptive to working on this competition? ____ Yes ____ No

Comments _____

How can we improve this program? _____

Please use additional space as needed and return these comments to:

2010-2011 National Chair: Vicki A. Cromer, CIT, CDS

c/o John T. Morgan Roofing & Sheet Metal Co., Inc.

1620 Sixth Street NE

Roanoke, VA 24012

Phone 540-342-7498

Fax 540-345-2959

Email –vacrom20@netscape.com

**NAWIC Education Foundation
CAD/Design/Drafting Scholarship Award Competition
2010-2011
Oral Interview Form
(Optional)**

The winning entry in the CAD category and Hand-Drafted category may be interviewed by a chapter committee member. The chapter committee member is to complete this form. This form should be utilized when either: a) the student narrative does not adequately describe the design and/or b) the entry requires verbal verification that the work is by the student and not completed by others.

Contestant Code: _____ Region: _____ Chapter: _____

1. Describe the overall concept of your project: _____

2. How did you come up with your design? What was your thought process? _____

3. Explain any special features that you have designed in your project. _____

4. Describe the flow of space in your project. _____

5. If you had more time, what would you have done differently, added, etc.?

Interviewer's additional comments: _____

(This form, if used, must accompany the entry at all levels of judging.)

Sheet A-3 Exterior Elevations (2) – 30 points maximum	
Line Weights & Lettering/Text Size – 7 points maximum	
Placement and Presentation – 8 points maximum	
Orientation and Accuracy – 5 points maximum	
Creativity – 10 points maximum	

Sheet A-4 Building Section and Wall Section – 30 points maximum	
Line Weights & Lettering/Text Size – 7 points maximum	
Placement and Presentation – 8 points maximum	
Orientation and Accuracy – 7 points maximum	
Creativity – 8 points maximum	

Sheet A-5 Electrical Plans – 25 points maximum	
Line Weights & Lettering/Text Size – 6 points maximum	
Placement and Presentation – 7 points maximum	
Orientation and Accuracy – 6 points maximum	
Creativity – 6 points maximum	

Sheet A-6/A-7 Optional Drawings – 20 points maximum	
Optional Drawing #1 – 10 points maximum	
Optional Drawing #2 – 10 points maximum	

Total Points – 180 points maximum	
--	--

Judges signature: _____ Date: _____

Your remarks are very welcome by the students:

**NAWIC Education Foundation
CAD/Design/Drafting Scholarship Award Competition
2010-2011 Student Application Form**

Submit form to: _____ Application Deadline: _____
Address: _____
Phone: _____ Fax: _____

I wish to enter the NAWIC Education Foundation CAD/Design/Drafting Scholarship Award Competition. I have read and agree to be governed by all the rules and specifications of the competition.

Please specify the type of drawing (choose one only): _____ CAD _____ Hand Drafting

Please print legibly:

Student's Name: _____ Age: _____ Grade: _____

Home Address: _____

City, State, and Zip Code: _____ Phone #: _____

School Name and Address: _____

City, State, and Zip Code: _____ Social Security #: _____
(required for distribution of cash awards.)

***Release:** I hereby consent to the use of my child's name or photograph in connection with promoting or publicizing the Foundation, or this specific event, now or in the future. On behalf of my child, I understand that his/her entry becomes the property of the NAWIC Education Foundation for its exclusive use. I further represent that this entry is the entrant's original work, and does not infringe on any patent, copyright, or other right of another, and on the entrant's behalf, I agree to indemnify the NAWIC Education Foundation against any claim of infringement or violation of the rights of another in the design entered.*

Student: (sign) _____ Teacher: (sign) _____

Parent/Guardian: (print) _____

(sign) _____

Cut here and submit the upper portion of this form as directed above

✂ =====

KEEP THIS PORTION IN A SAFE PLACE. For plan submittal, place this portion in a plain envelope and attach it to the back side of Sheet A-1 (Site Plan), in the upper left corner.

Deliver Plans to: _____

Student's Name: _____ Age: _____ Grade: _____

Home Address: _____

City, State, and Zip Code: _____ Phone #: _____

School Name and Address: _____

City, State, and Zip Code: _____

I certify these designs and drawings are my own, and I have not received any outside professional assistance. (Sign below.)

Student: _____ Teacher: _____

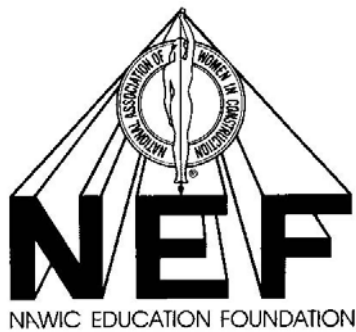

**NAWIC Education Foundation
CAD/DESIGN/DRAFTING
SCHOLARSHIP AWARD COMPETITION
2010-2011**

**Design Problem and
Project Requirements**

Design Problem and Project Requirements

1. Project Description

The project is a home for a family of five, the Walkers. They are moving into an older neighborhood in the city. The neighborhood is becoming popular for families to move into because of its accessibility to new commercial developments such as shopping and restaurants as well as public transportation. Your creativity and expertise will give you an opportunity to design additional houses in the area.

The surrounding houses were built sixty or seventy years ago. Some of them have been “rehabbed” so that on the outside they look much like they did when they were originally built, but have been updated on the inside with new fixtures and finishes. The Walkers have purchased an empty lot in the neighborhood and want a house that expresses some new ideas, but also keeps some of the patterns of the neighborhood.

Mr. Walker is an accountant and sometimes works at home. Mrs. Walker is a professor at the nearby university and often prepares her lectures at home. They both would like a shared home office away from the living and activity areas of the house.

The Walkers are looking forward to their own master bedroom and bathroom with adequate closet space. They have three children. Their daughter is a junior in high school and they have a son who is in eighth grade. They will each have their own bedrooms. They would like to have their own bathrooms, but Mr. and Mrs. Walker are not sure that they can afford a bathroom for every member of the family. Therefore, they would like to consider a shared bathroom for the two older children that could possibly be compartmentalized with separate sink areas, but shared bathing and toilet facilities.

A special concern for the Walkers is accommodations for their youngest son who is in fifth grade and has cerebral palsy. During the week he attends a private boarding school for children with disabilities; however, he spends the weekends and vacations at home with the rest of the family. The Walkers would like a bedroom for him on the first floor of the home with his own bathroom. The bathroom should have a roll-in shower and adequate space around the other fixtures to accommodate a wheel chair. This bathroom could be accessed from a hallway/common area or it could be accessed directly from the bedroom and combined with a connected powder room so that the lavatory and toilet area of the powder room can be used by the family without going through the bedroom, but then the shower and possibly another lavatory (if space allows) could be separated for the privacy. Although Universal Design is not required for all aspects of the first floor because this is a private residence, ease of access on the first floor should be considered, in particular by making all of the doors on the first floor three feet wide.

Mr. and Mrs. Walker enjoy cooking and want a large kitchen that includes a family activity space for the family to gather for meals, to do homework, watch television or play video games. The family has decided that they wouldn't use a separate formal dining room and would rather have a large dining area that is open to the kitchen and allows space for activities near the kitchen and for family gatherings with aunts, uncles and cousins. A separate living room for family gatherings and entertaining should be close to the kitchen and dining areas and have access to a patio or deck outside.

The site faces a residential street with an alley at the rear and another alley next to a vacant lot to the east. The Walkers want a garage or carport for one car and one van. They also need secure

storage for bicycles, lawn mower, gardening equipment and outdoor furniture. Access to the garage/car port can be from the alleys, and it can be either a separate structure or attached to the house. They do wish to have wheelchair access from the garage area to the first floor of the main house with a ramp (slope 1" per 1 ft.) or sloped sidewalk (slope 1" per 20 ft.). There are three large trees on the lot that the family wants to keep.

The Walkers have also requested these things in their new house:

1. A fireplace somewhere in the family activity area or living room
2. Computer set-ups in the family activity area and the home office
3. Walk-in closets in the master bedroom/bath
4. A laundry room

Other areas or rooms may be added as you think they are necessary. The total heated/cooled space cannot exceed 3,500 square feet (does not include the garage or any decks, porches or patios). The style of house should be appropriate for a house in your area. It may be stucco, brick, wood or vinyl sided, etc. with a low-sloped roof or steep-sloped roof. Zoning in this neighborhood permits houses to be 3 stories high with a maximum building height of 40 ft. to the highest point. This means that a third floor level is permitted, but if the roof slope is steep, this third floor space may likely be under the roof line (would not have full height walls, would have sloped ceilings, and dormer windows). A basement for mechanical systems is acceptable but not necessary.

2. Site Design

Students will redraw the Site Plan at a scale of 1" = 10'-0", using their school's software or drafting by hand. **There is no CAD file available.** There are two .pdf versions of the site plan available. A site plan formatted at 8.5" x 11" is included with the Design Problem and Project Requirements. A site plan formatted at 24" x 36" at the scale of 1" = 10'-0" is available on the NEF website. Go to www.nawiceducation.org, under K-12 Programs/CAD to download this file.

- A. Use the setbacks and restrictions as shown on the site plan. The building structure(s) cannot be located within the yard setbacks.
- B. Access to the garage/car port can be from either alley and can cross the adjacent vacant lot on the east side, but no buildings can be erected on the vacant lot.
- C. A sidewalk must be added in front of the site along Oakwood Avenue.
- D. The North Arrow should appear on the site plans and floor plans. On the Site Plan the North Arrow should point up with Oakwood Avenue at the bottom (South) and River Street at the left side (West). The Floor Plans can be shown on the sheet in the orientation that best works with the plan layout so that it fits on the page, but a North Arrow must be shown on the sheet.

3. Drawing and Submittal Requirements

- A. Submit a minimum of five (5) drawing sheets; a maximum of seven (7) drawing sheets on 24" x 36" paper.
- B. Each drawing sheet should contain:
 - 1" x 6" title block placed in the lower right-hand corner of each sheet shall include project title, date, student code number and drawing sheet number.
 - Appropriate labels for drawings and materials

- Required scale for each drawing labeled on the sheet
 - Accurate and readable dimensions
 - North Arrow where appropriate
 - Floor plans must be labeled with the North Arrow.
- C. Submit entries as Black Line photocopies of Black Line or Blue Line prints. Original computer plots may be submitted on bond paper only and in black ink only.
- CAD only – Computer plots or prints are required. DO NOT submit CD's, diskettes, plots on vellum or color ink plots. Drawings must be plotted at the required scale. DO NOT plot "Scale to Fit" the sheet size.
 - Hand Drafting only – DO NOT submit hand-drafted original drawings. All lettering is to be freehand and all drawings drawn by hand. Guidelines and straightedges for vertical strokes may be used for lettering.
- D. All submissions must comply with the requirements of the competition to be eligible for judging. Do not submit an incomplete set of drawings. All judges' decisions are final.
- E. All submitted sheets shall be stapled in the left-hand border with the Design Narrative stapled in the upper left-hand corner of Sheet A-1.
- F. The bottom portion of the signed student application forms shall be placed in a plain envelope and stapled to the back of Sheet A-1 (on the opposite side from the Design Narrative).
- G. The student's school name should not appear in the Title Block or in any place visible on the drawing sheets.
- H. Drawings will not be returned to the contestant.

4. Design Narrative

- A. The Design narrative is a statement about what the student feels are the positive and appropriate elements in the design and how the design meets the project description.
- B. Be creative! This is your first impression with the judges.
- C. Narrative will be 400 to 500 words and must be typed. Please use either Times Roman or Arial fonts in 10 pt. or 12 pt. – black ink please.
- D. Place the student code number in the upper right-hand corner of the narrative. DO NOT put the student name or school name on the narrative.
- E. Staple the narrative to the upper left-hand corner of the drawing set.
- F. Spelling and grammar will be considered. Do not rely on your computer's spell-checker.

5. Required Drawings

A. DRAWING SHEET A-1: SITE PLAN WITH ROOF PLAN

Scale: 1" = 10'- 0"

1. Students must use the site plan in the competition package.
2. Show the location of proposed building(s) on the site plan with the roof plan.
3. Show driveway and sidewalks on the site plan. Show paving, walks, curbs and existing trees to remain.
4. Show building setback lines and property lines.
5. Show the location of the building with dimensions to the property lines. (Setback requirements are shown on the site plan).
6. All students will be required to draw the site plan. **No CD, diskette or CAD file is provided.**

B. DRAWING SHEET A-2: Floor Plans

Scale: ¼" = 1'-0"

1. LABEL THE TOTAL ENCLOSED SQUARE FOOTAGE OF THE BUILDING ON THE DRAWING.
2. Show walls, windows, doors and door swings and openings along with appropriate dimensions for each. Show door and window sizes on the plan or provide a door/window schedule.
3. Show closets, built-in cabinets, plumbing fixtures and appliances. Optional (encouraged but not required): show furniture placement.
4. Show changes in floor elevation, stairs, stair landings and ramps.
5. Label each room or area (example: "Kitchen", "Master Bedroom") and indicate floor finishes for each room or area (wood, vinyl, ceramic tile, carpet, etc.).
6. Show section cut marks to correspond with Drawing Sheet A-5.
7. Optional (encouraged but not required): show shading of walls with accepted symbols to indicate wall construction materials

C. DRAWING SHEET A-3: Exterior Elevations

Scale: ¼" = 1'-0"

1. Show two (2) exterior elevations; one must depict the Oakwood Avenue (south) front elevation of the house, and one must depict either the right (east) or left (west) elevation.
2. Label the elevations as "South", "East", "West", etc.

3. Show walls, windows, doors, roof; indicate roof slopes.
4. Label all exterior finish materials (shingles, brick, stucco, siding, stone, etc.).
5. Show finish grades and the floor levels on each elevation.

D. DRAWING SHEET A-4: Building Section and Wall Section

Building Section Scale: Scale: $\frac{1}{4}" = 1'-0"$

1. Show footings and foundation walls, exterior and interior walls, floors, windows, ceilings and roof line.
2. Label rooms where the section is cut through.
3. Label different construction materials.
4. Dimension room heights and roof overhangs.
5. Optional items which can be shown (encouraged but not required): interior wall elevations

Wall Section Scale: $\frac{3}{4}" = 1'-0"$ or $1" = 1'-0"$

1. Show and label footing, foundation wall, floor slab or framing, typical exterior wall eave, roof structure and roofing materials.
2. Use break lines to shorten the wall section (if needed to fit the drawing on the 24" x 36" drawing sheet).
3. Show and label wall thickness and different construction materials (concrete, wood, insulation, sheathing, finishes, etc.).

E. DRAWING SHEET A-5: Electrical Plans

Scale: $\frac{1}{4}" = 1'-0"$

1. Show light switch locations, electrical outlets, TV/cable jacks, telephone jacks, computer data jacks or wireless hubs, lighting fixtures, ceiling fans, etc.
2. Show any lighting on the exterior of the building.
3. Show electrical symbol legend on your drawing.

F. DRAWING SHEETS A-6 and A-7: Optional Drawings (maximum of two)

1. Additional two (2) elevations not shown on Sheet A-3. Follow instructions for Sheet A-3.
2. Additional building sections and/or wall sections. Follow instructions for Sheet A-4.
3. Interior Elevations (scale $\frac{1}{2}" = 1'-0"$) for the kitchen and bathrooms.

4. Exterior or interior perspective sketch.
5. Landscape Plan (this is a separate drawing from the Site Plan) at 1"=10'-0" showing new plantings, trees, shrubs and their names.

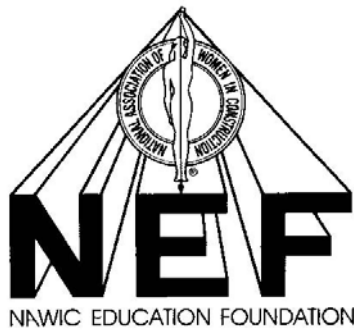

**NAWIC Education Foundation
CAD/DESIGN/DRAFTING
SCHOLARSHIP AWARD COMPETITION
2010-2011**

Resource Material

SITE PLAN

(not printed to scale)

A .pdf of the 24" x 36" site plan at the scale of 1" = 10'-0" is available on the NEF website. Go to www.nawiceducation.org under K-12 Programs/CAD to download.

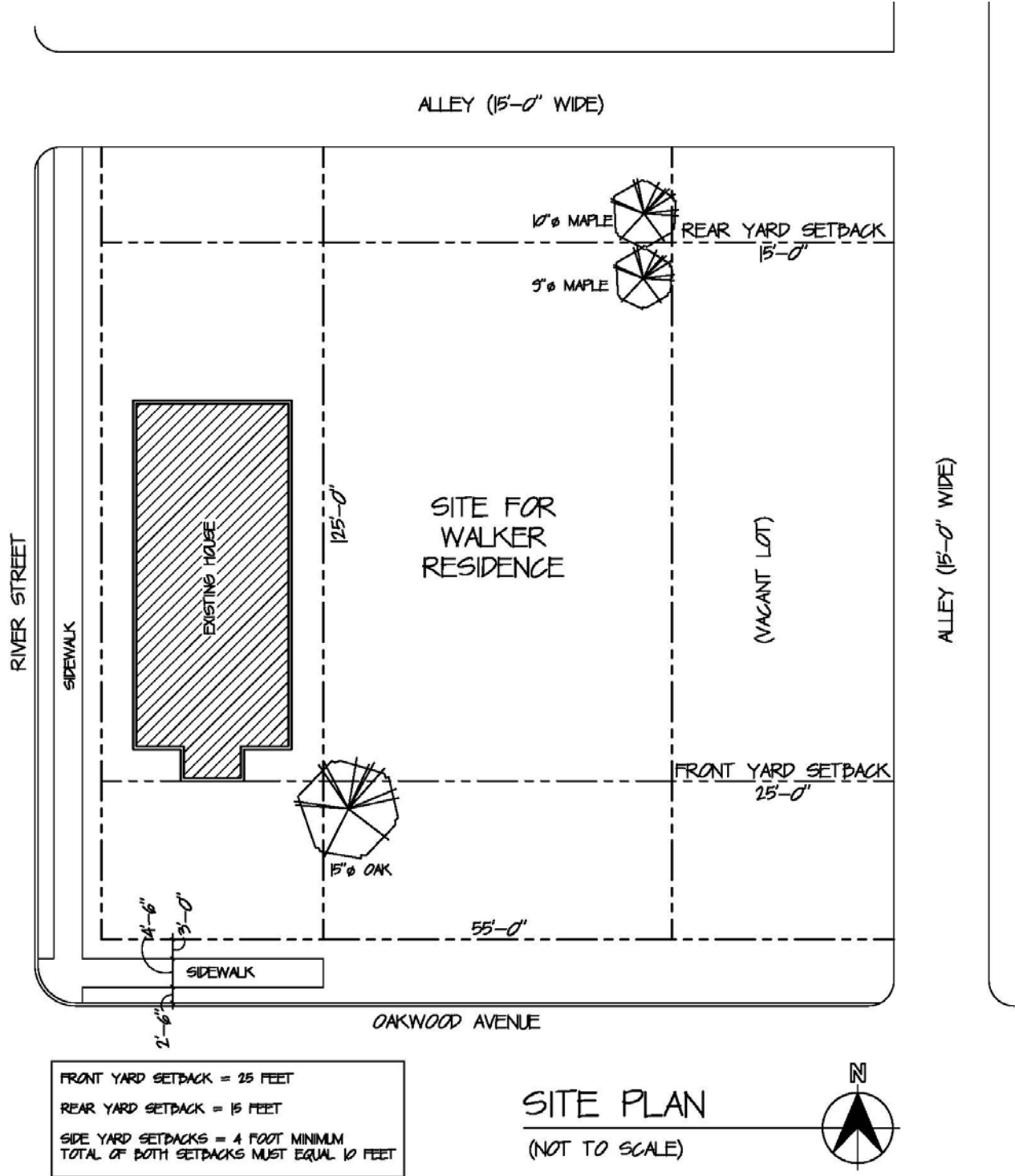

Design Resources

1. Energy Efficiency

The Walkers would like their new home to be as energy-efficient as possible. Energy efficiency is just one aspect of "green" building design, and new construction is an ideal opportunity to explore "green" design. Here are some of its principles:

- Energy efficiency and alternative energy sources in the building's plumbing, heating/ventilation/air conditioning systems (for example, passive or active solar energy, heat pumps, appropriate building location on the site)
- Use of building materials with less of an environmental impact than traditional materials (for example, fiber-cement siding, recycled lumber or stone, wall-board panels using recycled material, paints and adhesives that do not give off toxic fumes)
- Consideration of transportation costs and manufacturing processes in selection of materials and suppliers

"Green" building is an extremely important element of responsible design and construction. A good starting place for your research is the website of the U.S. Green Building Council:

www.usgbc.org

2. Universal Design and Accessibility

Although this is a private residence, the Walkers would like some consideration for accessibility on the first floor level of the house for ease of mobility for the youngest son. There are Universal Design guidelines specifically for residential dwelling units.

The following resources will provide the necessary dimensions and clearance information to make the home more accessible:

- ADA Standards for Accessible Design
www.ada.gov/stdspdf.htm

Guidelines are available in both .pdf and html formats

- International Code Council American National Standard Accessible and Usable Buildings and Facilities ICC/ANSI A117.1 most recent addition.

3. Design Ideas

Here are some websites, books and magazines to look at as you are designing the Walker's new home.

A. Architect Sarah Susanka has written three books with many project photos of "not so big" houses that meet clients' needs with ingenious and beautiful ideas. These books are widely available in bookstores.

[The Not So Big House](#)
[Creating the Not So Big House](#)
[Home by Design](#)

Visit this website for more information and ideas: www.entsobighouse.com

B. A Traditional Neighborhood Development can be defined as an “approach to designing cities, towns, and neighborhoods.” The goal being not only to reduce urban sprawl, but to create communities where people live, and work and socialize. Revitalizing, rebuilding and renovating urban neighborhoods can also be viewed as “green” design. The New Urbanism movement includes design principles for creating “ ‘small towns’ and neighborhoods where people work, live, play, and walk from place--is on.”

While the Walkers are not building a house in one of these planned communities, some of the principles and ideas in the book [The New Urbanism: Toward an Architecture of Community](#) by Peter Katz and Vincent Scully be a useful resource in designing a home on a narrow lot in and urban community.

The City of Roanoke, Virginia has put together a pattern book for residential architecture, [Residential Pattern Book for the City of Roanoke](#). “In developing the Pattern Book, the City of Roanoke strives to preserve and enhance the character and quality of its residential neighborhoods. The Pattern Book is a design aid for new construction and renovation of residential buildings...But most importantly it is intended to instill pride in homeowners and encourage them to preserve the unique character of their homes and neighborhoods.” The Walkers do not necessarily live in Roanoke, Virginia and, therefore, the designer does not need to exactly follow the design direction and requirements in this Pattern Book. However, this is a good resource for ideas and understanding what is meant for a new home to fit into the historic character of its neighborhood.
<http://www.roanokeva.gov/85256A8D0062AF37/vwContentByKey/N27ANQJY490FGUREN>

C. [Fine Homebuilding](#) magazine, published by Taunton Press six times a year, also has good information about custom-designed houses. It is geared for professional builders, so there is technical information about tools and construction methods. Website: www.tauntonpress/finehomebuilding.com

4. Field Research

One of the best resources that you have is to look at the buildings around you.

- Many community organizations sponsor house tours. Attend one of these and keep a list of ideas you see that you like.
- Write down a list of questions as you begin designing. Ask a residential architect to visit your class and discuss some of these questions.
- Visit a historic or famous house that's open to the public in your area. Notice and write down what you like and don't like. Use these ideas as you design.
- What do you like/dislike about your own house? What would you change?